

BAPI Interlock

Dome head · Aluminium body · Aluminium stem · Multi-grip
4.8 mm (3/16") - 6.4 mm (1/4")

Features

- Multi-grip structural breakstem fastener
- Excellent hole fill via radially expanded body provides greater joint integrity, added water resistance and compensates for irregular, oversized, slotted or misaligned holes
- Can stop sheet movement in non-standard holes
- Good sheet take-up performance for large gap closing capability
- Stem mechanically locked into body avoids damage, electrical problems or rattling caused by loose stems
- High shear and tensile strength

Material

- Body: Aluminium alloy (5% Mg) A5056, natural
- Stem: Aluminium alloy (7178), natural

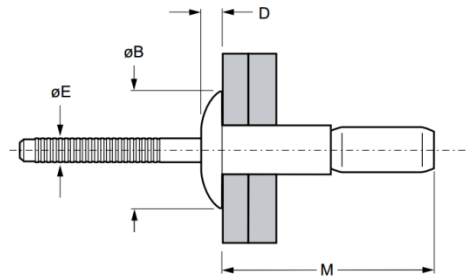

Before Placement

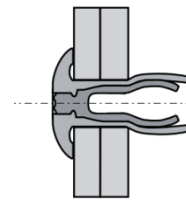

After Placement

Part No.	Size ø	Grip Range		Hole Size		M max.	øB max.	D max.	øE max.	Shear (typical) kN	Tension (typical) kN
		min.	max.	min.	max.						
BAPI-06-04	4.8 (3/16")	1.57	6.86	4.93	5.18	21.39	10.16	2.29	3.10	3.34	2.22
BAPI-06-07		5.44	11.10			22.23					
BAPI-E06-07		1.57	11.10			24.77					
BAPI-06-10		9.53	15.88			27.69					
BAPI-08-06	6.4 (1/4")	2.03	9.53	6.63	7.01	30.00	13.46	2.97	4.11	6.23	4.00
BAPI-08-10		8.89	15.88			33.02					
BAPI-E08-10		2.03	15.88			35.56					



Can't find what you are looking for?

We can provide customized finishing and colouring.
Contact your nearest [Gripwell](http://www.gripwell.com) team for assistance!